

LOCATION:

At the intersection of W. Georgia Road and East Standing Springs Road. The property sits directly across from a Walmart Neighborhood Market and a 30,000 SF GHS medical office building.

FACTS:

- Anchor: Publix Supermarket
- Size: 48,000 SF grocery with 15,500 SF of shop space
- Availability: Restaurant and shop space from 1,440 to 2,900 SF
- Traffic: W. Georgia Rd. 18,700 AADT
 Stenhouse Road 7,500 AADT

SNAPSHOTS:

- The Center will be accessed via a main entrance off W. Georgia Road and two additional access points on East Standing Springs Road. An existing traffic signal benefits the site at the intersection of these two roads.
- West Georgia Road is one of Greenville’s fastest growing residential areas.
- The area includes 18,000 households, with 1,500 units under construction or proposed.
- Construction began November 2019 with an estimated project opening late 2020.

DEMOGRAPHICS:

2019 Estimates	2 Mile Radius	3 Mile Radius
Population	26,898	45,288
Population Growth '10-'19	2.7%	2.5%
Avg. Household Income	\$80,773	\$80,591
Median Age	36.3	36.6



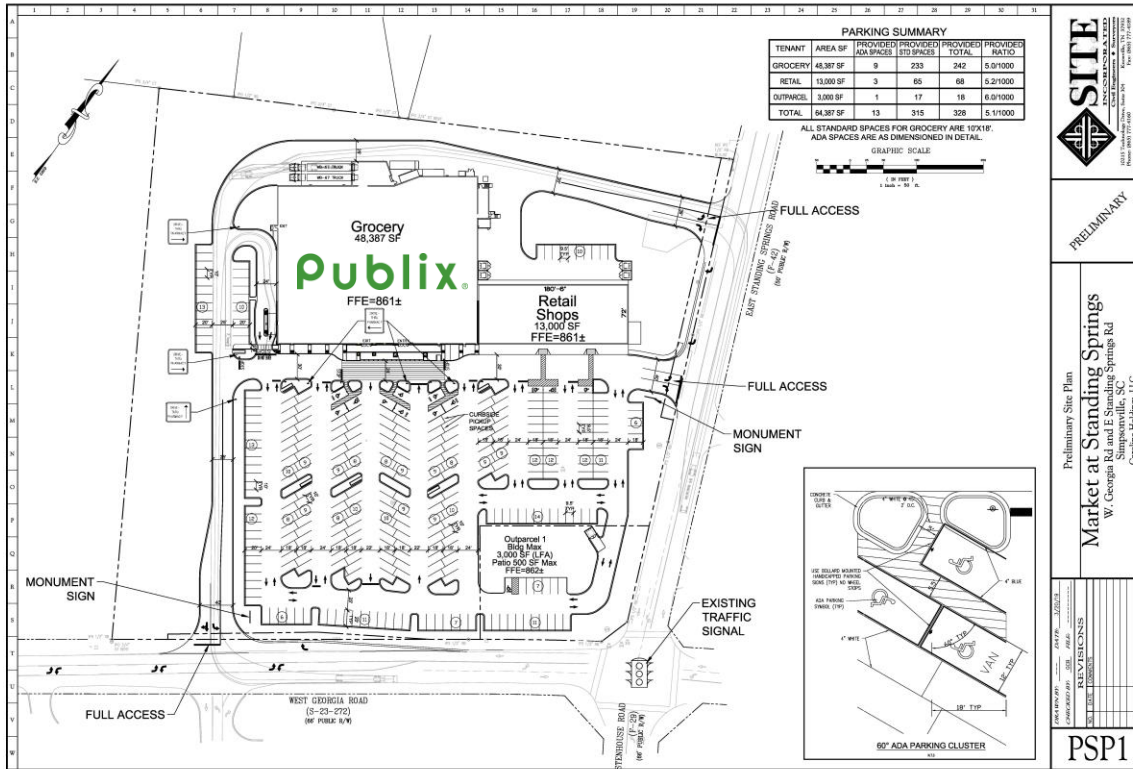

SITE
 PRELIMINARY
 Preliminary Site Plan
Market at Standing Springs
 W. Georgia Rd and E Standing Springs Rd
 Simpsonville, SC
 Carolina Holdings, LLC

DATE: 07/20/2023
 DRAWN BY: R. VANCE
 CHECKED BY: J. WOOD
 PROJECT NO: 2023-001

PSP1

AVAILABLE

Publix.

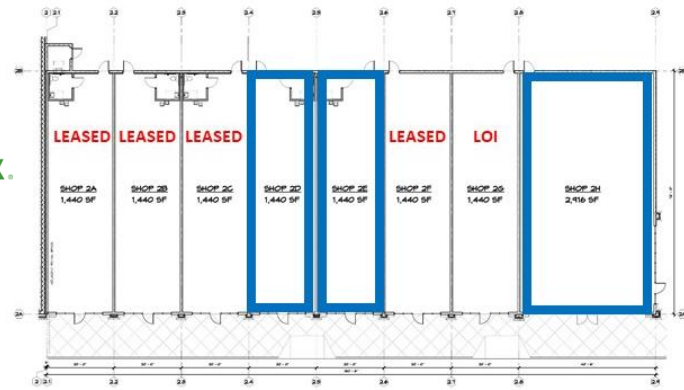

1 FLOOR PLAN
 SCALE: 1/8" = 1'-0"



2 SHOPS FRONT ELEVATION
 SCALE: 1/8" = 1'-0"

For information, contact:

David Winburn
 864-272-0088 / 800-763-8088
 david.winburn@choldings.com

