



**LOCATION:**

5 Farris Bridge Road  
 Greenville, SC

**FACTS:**

Available

Space: 10,400 SF and 6,950 SF  
 (Spaces can be combined to provide 17,350 SF)

Anchor

Tenants: BI-LO, Roses, AutoZone,  
 Cash America

Traffic: Farris Bridge 13,000 CPD  
 White Horse Rd 16,900 CPD

**COMMUNITY:**

- Westowne is the primary grocery-anchored center in the western Greenville community of Berea.
- Located at the signalized intersection of Farris Bridge and Hunts Bridge Roads—the main location in Berea.
- Westowne is anchored by national and regional tenants and surrounded by plentiful retail and residential communities.
- Anchor tenants with above-average store sales.

**DEMOGRAPHICS:**

2015 Estimates	3 Mile	5 Mile
Population	43,235	98,549
Avg. Household Income	\$39,576	\$49,863
No. of Households	16,861	39,386

**NEIGHBORHOOD:**

Wells Fargo	SunTrust Bank	Subway	Hardees	Dollar Tree
BB&T	Bank of America	Dollar General	Title Max	
Cornerstone Bank	Wendy's	O'Reilly	Berea Elementary School	



**AERIALS:**

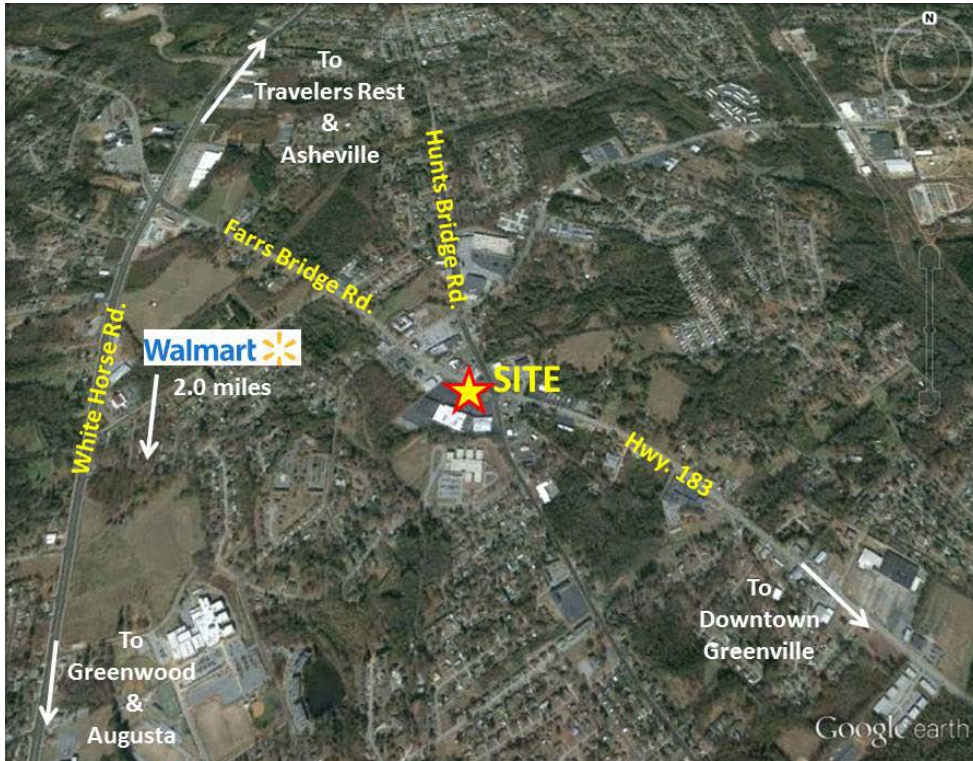



**SITE PLAN:**

C-2 ZONING RESTRICTIONS S/E:  
[http://www.greenvilleplanning.com/land\\_dr](http://www.greenvilleplanning.com/land_dr)

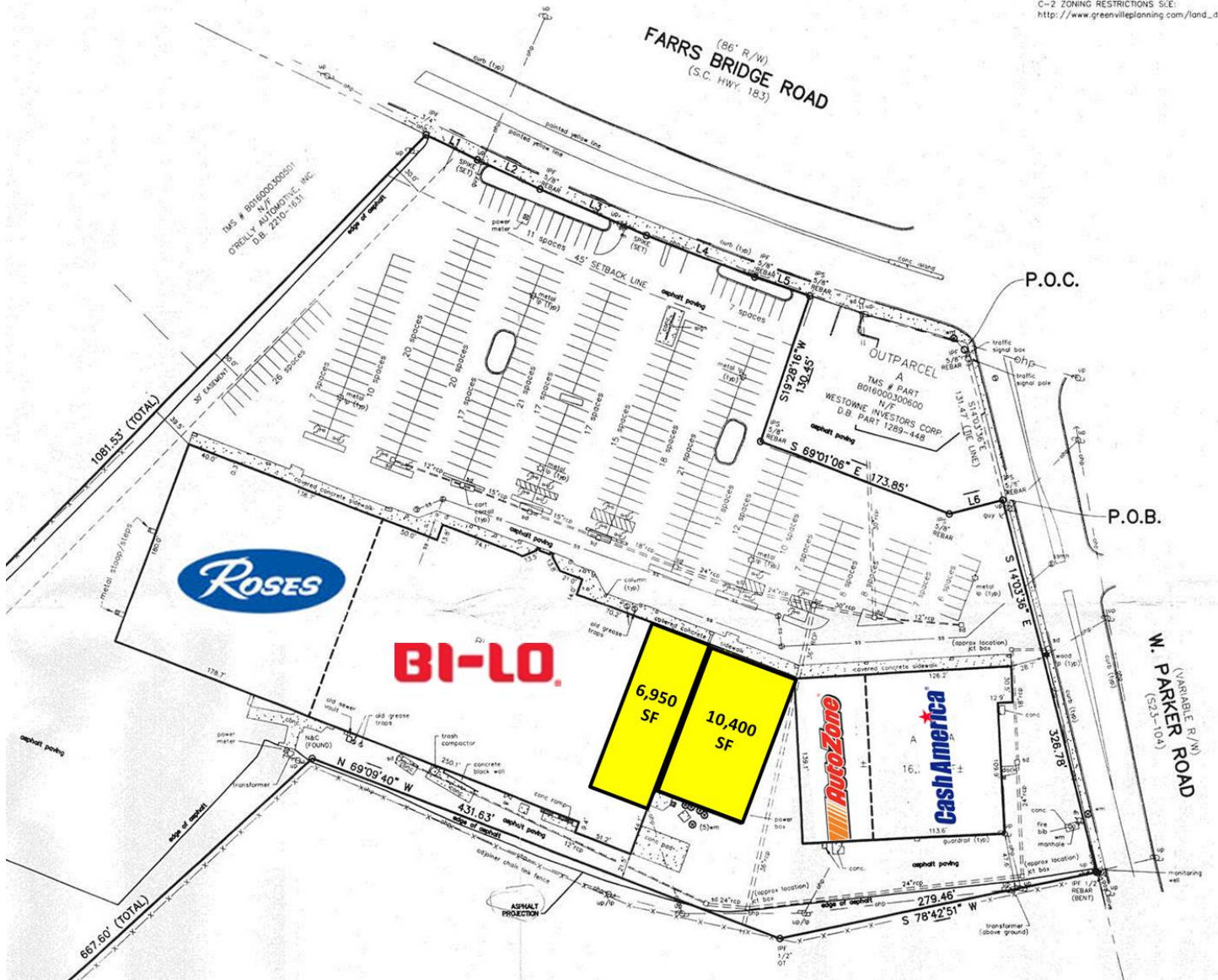

**For information, contact:**

Robert Martin  
 864-272-0088  
 robert.martin@choldings.com

